

The Meridian Theatres at Centrepointe Studio is an intimate space which offers flexibility in its uses and configurations. The studio is ideal for intimate performances, cabaret and dinner theatre, business functions, lectures, rehearsals, master classes and workshops. It is acoustically sound and fully equipped with state-of-the-art lighting and sound systems, tension grid, a sprung floor and retractable seating.

CONTACT INFORMATION

Address

Ben Franklin Place
101 Centrepointe Drive
Ottawa, ON K2G 5K7
meridiancentrepointe.com

Telephone

Administration	(613) 580-2701
Box Office	(613) 580-2700
Box Office – Toll Free	(866) 752-5231
Production	(613) 580-2703

Key Contacts

Artistic Producer and Manager	Allan Sansom	(613) 580-2424 x46653
Chief, Production and Rental Services	Sean Freill	(613) 580-2424 x41527

UNIONS

Stage

International Alliance of Theatrical Stage
Employees (IATSE – Local 471)

Administration

Canadian Union of Public Employees (CUPE)
Civic Institute of Professional Personnel (CIPP)

GENERAL INFORMATION

Volunteers

Non-Profit organizations have access to the Theatres Volunteer Stage Crew. In the absence of available volunteers, IATSE union staff will be hired and charged back at the applicable rates.
The Licensee shall provide the Volunteer Stage Crew with appropriate meals and refreshments during the engagement at scheduled times as advanced by Production Services.

Haze and Theatrical Smoke

Productions using haze and smoke must inform Meridian Theatres in advance of their event.
WHMIS 2015 documentation (SDS) must be provided to Production Services.

Pyrotechnics

Productions using pyrotechnic special effects must apply for and receive a permit in accordance with City Of Ottawa bylaw services and obtain authorization from the Theatre, and the Fire Chief of the City of Ottawa.
Operators must hold valid certification from the Explosive Regulatory Division of the Natural Resources of Canada.

Open Flame

The City of Ottawa has a No Open Flame policy.

Theatrical Firearms/Weaponry

All firearms, including replica firearms, must be handled in accordance with federal legislation. Advance approval required by Production Services.

Maximum Sound Levels - Refer to Ontario Ministry of Labour Safety Guidelines for Live Performance Industry.
<https://www.labour.gov.on.ca/english/hs/topics/performance.php>

Recording

No video and/or audio recording is permitted without prior approval from Meridian Theatres. Additional IATSE fees may apply. For full details on reproduction and broadcasting, please consult the *General Terms and Conditions*.

Occupational Health & Safety

Smoking is not permitted in Meridian Theatres or anywhere on City of Ottawa property.
Safety footwear and hard hats as required in accordance with Ontario Ministry of Labour (MOL) regulations.
Fall protection is mandatory in accordance with MOL regulations.

STAGE – see attached floor plan	
Stage Surface Masonite painted black over plywood sprung floor. Anchoring (screwing) into the floor is not permitted.	
Dimensions	<i>Stage to High Transfer Area</i>
<i>Useable floor area with no seating</i>	<i>Door</i> 3.4 m (11'-1")
Width (middle of room): 15 m (49'-3")	Maximum width: 3.9 m (12'-11")
Depth (backdrop to retracted seating): 16.3 m (53'-5")	Maximum height:
<i>Playing Area</i>	<i>Rigging</i>
<i>with Standard Seating</i>	Height (floor to Tension Grid): 6.2 m (20'-3")
Width: 12.2 m (39'-3")	
Depth (Setline to backdrop): 9.3 m (30'-7")	
<i>with OPTIONAL pit seating</i>	
Width: 12.2 m (39'-3")	
Depth (Setline to backdrop): 6.3 m (20'-7")	

SEATING OPTIONS
Standard Seating – 199 seats plus 4 wheelchair locations
Pit Seating – 233 seats plus 4 wheelchair locations, additional production fees will apply
No Seating – theatre seating retracted

MASKING	
House Curtain (Main) No house main curtain	Border - Black Velour, 0% fullness 4 – 3.7 m wide x 1.3 m high (12'-0" x 4'-3") Black velour drape on curtain track to mask off entrance area stage left, right and arcade openings on the gallery level.
Back Drop - Black Velour on motorized lineset 2 – 7.3 m wide x 5.9 m high (22'-0" x 19'-4")	
Cyclorama 1 – Muslin Cloth 12.2 m wide x 5.8 m high (40'-0" x 19'-0")	

RIGGING
Tension Grid System Tension Grid System is comprised of interwoven 1/8" (7x19) galvanized cables strung in tension on 2" centres and contained within a structural steel frame that is suspended from hanger points below the studio's structural steel. The tension grid is over the entire floor area of the studio. Lighting pipes are above the tension grid to allow for greater flexibility and ease of focus.
Any production that requires rigging from structural steel must advance with Production Services. No rigging from tension grid frame.

AUDIO	
Installed mix position in centre of studio control booth. Windows in control booth do open.	
<p>FOH PA</p> <ul style="list-style-type: none"> 4 – Meyer UPQ-1P (2/side flown) 2 – Meyer 500HP Subwoofer (flown centre) 1 – Meyer Galileo 408 processor for control <p>Monitors</p> <ul style="list-style-type: none"> 8 – EAW MW12 MicroWedge 4 – Crown iTech 5000HD Amplifiers – 4 mixes 2 – QSC K8 Power Speakers (flown SL & SR) 2 – JBL LSR2328P (mounted in Control Room) 3 – Yamaha MS101III for Booth Program Sound 4 – Berhringer B205D compact monitor speaker 	<p>FOH Console, Processing & Playback</p> <ul style="list-style-type: none"> 1 – Yamaha M7CL-48 v3 (48 mono + 4 stereo) 2 – Denon DN-300C MKII CD/Media Player (USB) 1 – Tascam CD-200i CD Player / ipod dock <p>Patching</p> <p>All house patch points terminate to bantam(TT) patchbays in Control Booth.</p>

<p>Microphones and DIs</p> <ul style="list-style-type: none"> 6 – Shure SM58 6 – Shure SM57 1 – Shure Beta 52A 3 – Shure SM81 2 – Sennheiser MK4 3 – Sennheiser e904 with drum clip 3 – Crown PCC 160 6 – Radial JDI Passive DI box 1 – Whirlwind PCDI <p>Wireless</p> <ul style="list-style-type: none"> 2 – Shure UHF-R UR4D Dual Receiver (H4 Band 518-578 MHz) 4 – Shure UR2/SM58 wireless handheld 4 – Shure UR1 wireless body pack transmitters with Shure WL184 lav mic or ¼” cable 	<p>Stands</p> <ul style="list-style-type: none"> 12 – K&M 210/9 Tall mic stand with boom- Black 12 – K&M 259 Short mic stand with boom- Black 8 – table top mic stands <p>Intercom System</p> <p>WIRELESS</p> <ul style="list-style-type: none"> 1 – Clearcom Tempest 2400 CM-222 base station 5 – Clearcom Tempest CP-222 belt packs <p>WIRED</p> <ul style="list-style-type: none"> 1 – Clearcom MS702 station (booth SM position) 1 – Clearcom RM702 station (booth audio position) 1 – Clearcom KB702 station (booth lighting position) 4 – Clearcom RS-601 belt packs (1 channel) 10 – Clearcom CC-95 headsets (single muff) <p>Assistive Listening System</p> <p>Brahler MSI-8d IR Transmitter with IR Radiator</p>
--	--

PRODUCTION POWER SOURCE		
	Lighting	Audio
LOCATION:	Grid Level-upstage right	4 x SL & 4 x SR on upstage wall
CAPACITY:	400 Amp	20 Amp
PHASES:	3∅	1∅
VOLTAGE:	120/208 volt, 60 Hz, 5 wire	120 volt, 60 Hz
CONNECTORS:	Cam-Loc E1016 Female	Edison U-Ground

LIGHTING – see meridiancentrepointe.com/en/rentals/studio/index.htm for LX Rep plot

The Studio is equipped with a pre-hung and coloured stock lighting plot.
The stock lighting plot must be restored at the production's expense if any changes are made.
House light control from booth or stage right.

Console

1 – ETC ION 1000 (eOS v 2.7.3)
with 2 x 20 Fader Wings
and wireless NET3RFR remote

Dimmers

2 – ETC Sensor+ 96 channel racks
All wired dimmer per circuit (2.4kW)

Circuits

186 – 20A (Mix of L5 Twistlock & Socapex)

Control Protocol :

ETC sACN/eDMX Network
Additional Gateways available.

Followspots

2 – LDR Canto – 1k

Mirror Ball

1 – 20" mirror ball with 1 RPM motor

Subject to availability (shared with theatre):

Hazer

2 – Ultratec Radiance Hazer with fan

Fogger

2 – Martin Jem ZR44

Fixture Inventory

Type	Total Inventory	Used in Stock Plot	Available
ETC Source Four - 19°	14	14	0
ETC Source Four - 26°	27	21	6
ETC Source Four - 36°	29	28	1
ETC Source Four - 50°	4	0	4
ETC Source Four - 25-50° Zoom	10	4	6
ETC Source Four – Par Medium	25	10	15
ETC Source Four – Parnel	35	31	4
ChromaQ CF12 LED RGBA	12	6	6
Altman Cyc - 3 CELL	4	4	0
Martin MAC250 entour	4	4	0
	164	122	42

* subject to availability

** all ETC fixtures use HPL 575 Watt bulb

VIDEO

Projector

- 1 – Panasonic PT-DZ6710U HD 6000 lumen DPL
Stock Lens installed: ET-DLE350 3.6 - 5.4:1

Projection Screen – flown upstage centre when required.

- 1 – Draper Cinefold 4.26 m x 3.05 m (14'-0" x 10'-0") with Fast Fold flyable truss frame.
4:3 ratio, Uniflex front projection surface

Switching

- 1 – Extron Video Matrix Switching System (Analog RGB) OR HDMI over HDBase-T

Playback

- 1 – Tascam BD-R2000 Blu-ray player

Users must provide laptop/computer if required for playback/presentations.

Miscellaneous Equipment

Some of the following equipment is shared between Meridian Theatres Mainstage and the Studio Theatre. Please inquire about availability with Production Services during show advance. Subject to availability.

Pianos (A=440, mandatory tuning required)

- 9' Yamaha CFIII Concert Grand Piano
- 6' Yamaha GS6 Grand Piano

Orchestra

- 16 – Black Orchestra Chairs (padded, no arms)
- 15 – Black Music Stands
- 15 – Music Stand Lights
- 1 – Conductor Podium 0.9m x 0.9m (3'x3')

Audio Equipment

- 1 – Whirlwind PressPower2 Media Box
- 2 – QSC K8 Powered Speakers

Podium

- 2 – Wood Podium

Pipe & Drape kit

Risers

Black plywood lids on folding bases

- 5 – 1.2m x 2.4m x 0.15m (4' x 8' x 6")
- 2 – 1.2m x 2.4m x 0.41m (4' x 8' x 16")
- 5 – 1.2m x 2.4m x 0.46m (4' x 8' x 18")
- 5 – 1.2m x 2.4m x 0.76m (4' x 8' x 30")

Dance Floor

- Rosco Reversible Black / Gray
- 5 Rolls – 1.6 m (5¼') x 12 m (40')
- 60 – Black Masonite 1.2m x 2.4m (4' x 8') sheet

Other Furniture

- 4 – Metal Stools ~ 28" high
- 3 – Black Tables 6' x 2'-6"
- 2 – Black Tables 6' x 1'-6"

BACKSTAGE – floor plans available upon request

Stage Door – North side of Ben Franklin Place (See attached map)

All cast and crew are required to enter here and check in with Stage Door Attendant

Greenroom – one floor up from stage level

Chairs and Tables. Stove, Coffee maker, Microwave, Fridge, Ice Machine

Servery – stage right hallway

Sink, Microwave & Fridge

Dressing Rooms – stage right hallway

2 – Large dressing rooms with dressing tables, mirrors, clothing racks. 13 stations per room.

Private shower, toilet and sinks in each dressing room.

Wardrobe Room – end of dressing room hallway

One high efficiency (HE) washing machine and one dryer. Ironing boards and steamer available.

Loading Docks (shared with mainstage space)

2 – Indoor truck level docks. Can accommodate vehicles up to 22.8m (75') in length.

14 m (46') push to Stage Left. All shows must load-in through the LOADING DOCK.

Interior Loading Doors: Max. Height 2.7 m (8' 10") Max. Width 2.4 m (7' 10")

Parking

There is free parking in the main lot of Ben Franklin Place.

Parking is not permitted along the loading dock access ramp. Dock access must remain clear.

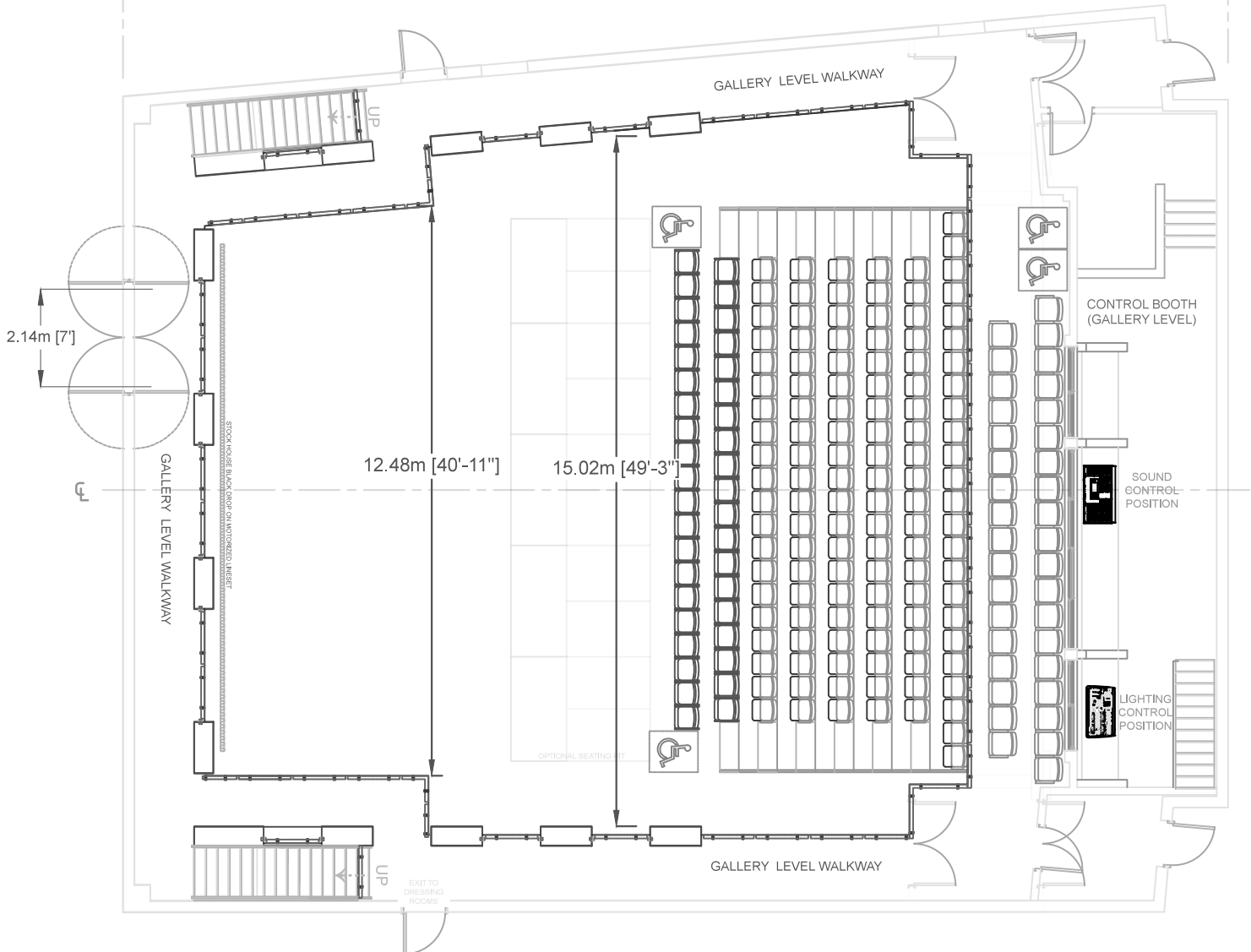
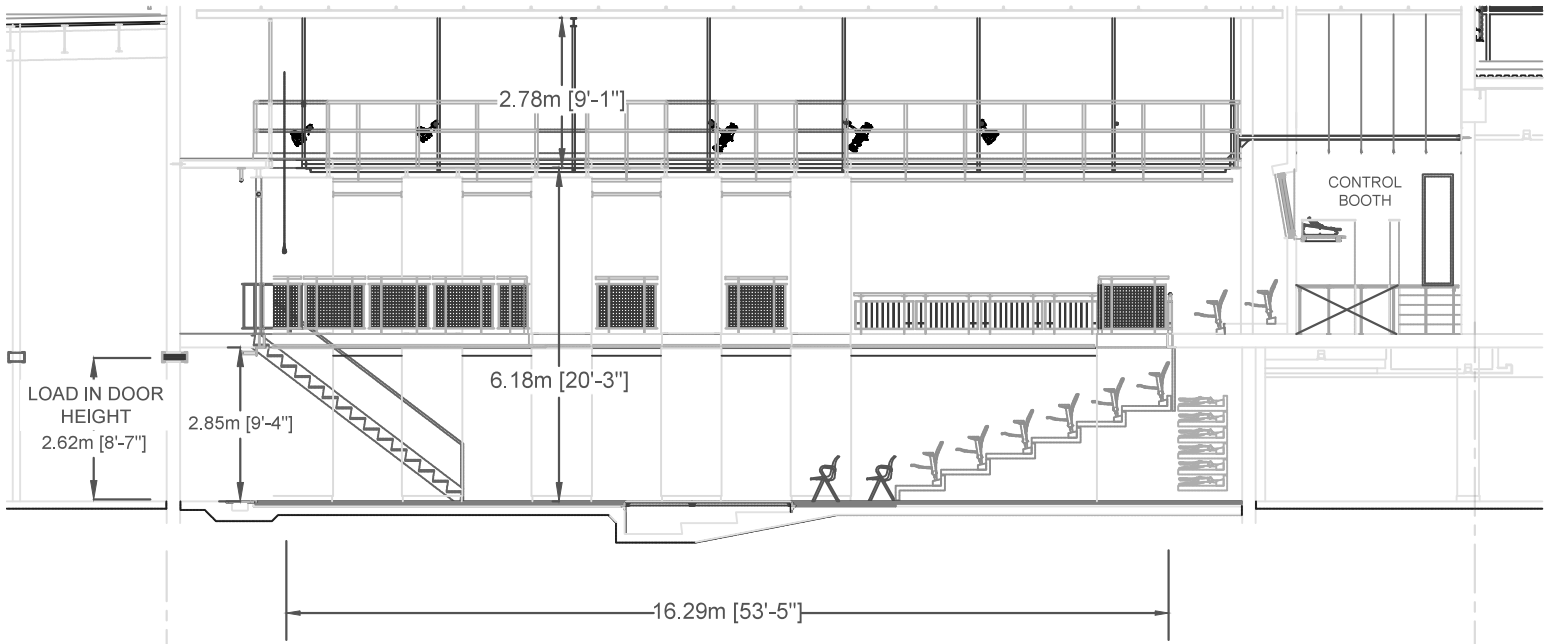

Studio du Théâtre Meridian Theatres @ Centrepointe - Studio
 Plan & Section View, Voir plan et coupe
 Configuration standard configuration

199 seats & 4 wheelchair locations, 199 sièges et 4 places pour fauteuil roulant

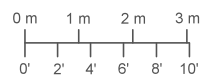

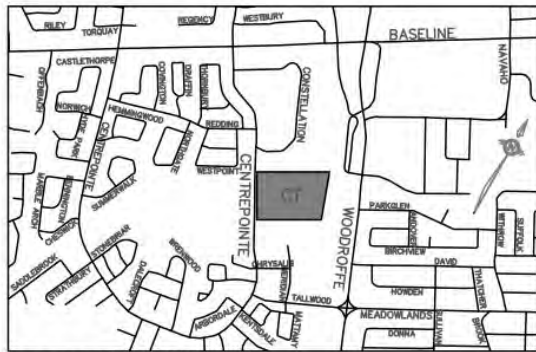

MAP NOT TO SCALE



Meridian Theatres at Centrepointe
 101 Centrepointe Drive, Ottawa, ON K2G 5K7
 613-580-2703 - Production/Stage Door
 Google Map Link: <http://g.co/maps/km5vn>

**ALL CAST AND CREW TO ENTER BY
 STAGE DOOR ENTRANCE**

**Follow arrows to access the theatre loading docks
 for theatre deliveries and pickups.**